

***XHD Lithium
Cordless Blower
Brushless 36V (2x
18V) - Bare Tool***

TSC24

XHD
LITHIUM



OPERATORS MANUAL



TABLE OF CONTENTS

Specifications	3
Product Identification	4
Safety Guidelines	5
Operation	9
Assembly	10
Operation	11
Maintenance	13
Storage	13

Note

This manual is for your reference only. Due to the continuous improvement of the XHD Lithium products, changes may be made at any time without obligation or notice.

Thank You

For the purchase of this XHD Lithium product. We try our hardest to supply customers like you with the best quality products available, at the best price possible. We cant wait to continue working together in the future.



SPECIFICATIONS

Battery	2x 18 Volt Li-Ion
Air Speed (Normal Mode)	83–108 km/h
Maximum Air Speed (Turbo Mode)	180 km/h
Air Volume (Normal Mode)	356–667 m ³ /h
Maximum Air Volume (Turbo Mode)	775 m ³ /h
Rotation Speed (Normal Mode)	11,000–16,000 RPM
Maximum Rotation Speed (Turbo Mode)	22,000 RPM
Net Weight	2.3 KG

Intended Use

The cordless blower is intended only for outdoor use, in dry and well-illuminated conditions. The product is intended for blowing light debris including leaves, grass, and other garden refuse.

PRODUCT IDENTIFICATION

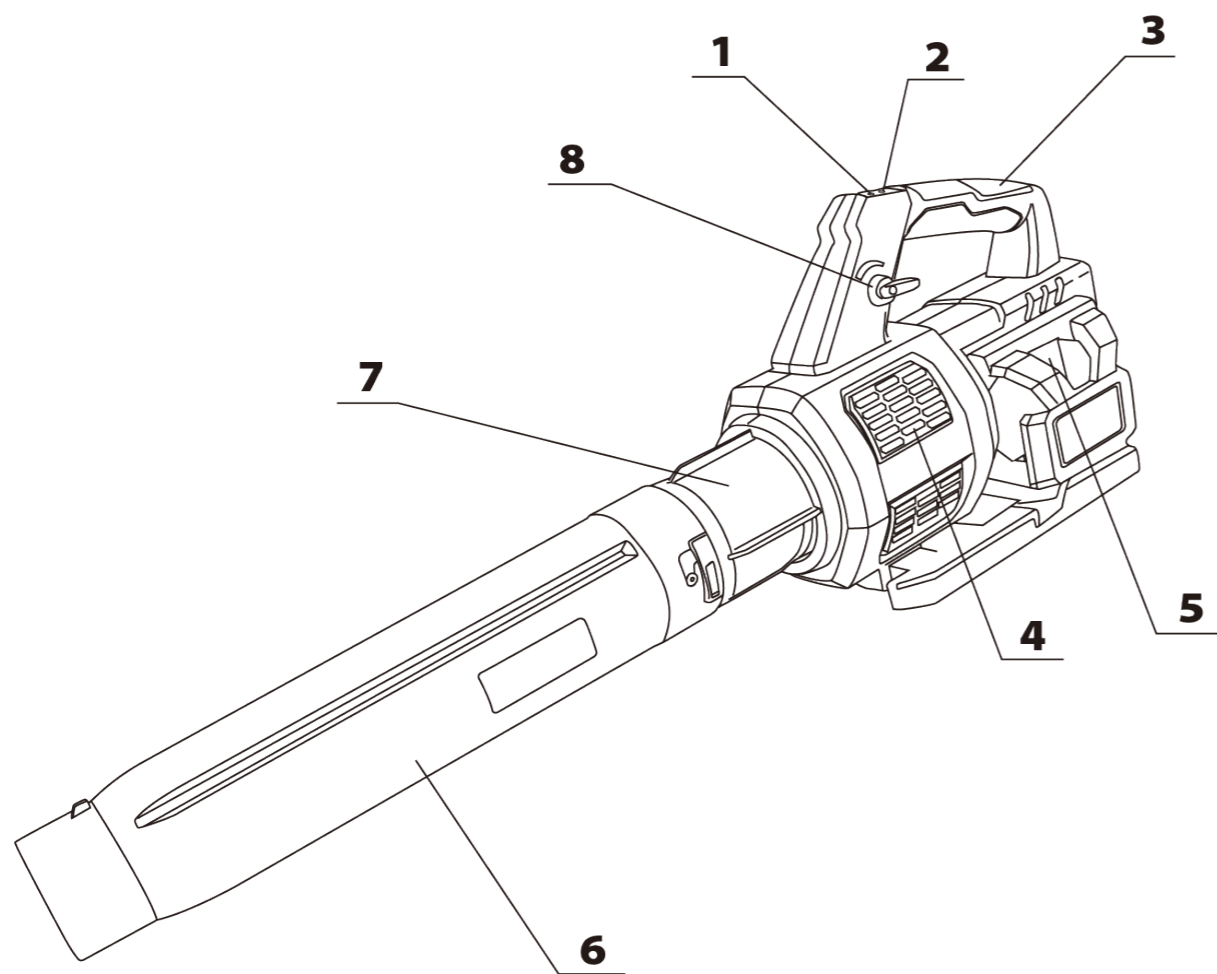

- 1 On/Off Switch
- 2 Turbo Speed Switch
- 3 Handle
- 4 Air Intake Vent
- 5 Battery Connection Port
- 6 Blower Tube
- 7 Blower Outlet
- 8 Variable Speed Adjustment Lever

SAFETY GUIDELINES

! WARNING

READ ALL SAFETY WARNINGS & INSTRUCTIONS. Failure to follow instructions and warnings could lead to serious injury, electric shock, or fire.

Work Area Safety

- **Ensure that your work area is kept clean and well lit.** Lack of visibility and clutter greatly increase the risk of accident when using tools.
- **Keep bystanders, pets, and children clear when operating this power tool or machine.** They can cause distraction or risk injury to themselves.
- **Ensure you are not operating the power tool or machinery in the presence of dust, liquids, flammable gases, or anything that can create an explosive atmosphere.** Power tools and machinery can create sparks which can lead to ignition and fire hazards in working environments.

Personal Safety

- **Always wear personal protective equipment (PPE).** Eye protection, ear protection, dust masks, and other protective equipment will help to reduce the risk of personal injury or long-term illnesses.
- **Dress appropriately. DO NOT wear loose clothing that can get caught in moving parts.** Keep hair, loose clothing, jewellery, and anything else that could be of risk, away

from moving parts in the machine, or they could become caught therein.

- **Always remain alert and DO NOT operate power tools or machinery under the influence of any substances such as alcohol or drugs, including prescription medications.** Lack of focus could lead to injury or accidents while operating these power tools and machinery.
- **Always ensure proper footing and balance.** Overreaching can lead to slipping and falling which can result in injury or accident.
- **Ensure the power switch is in the OFF position before connecting any battery, or power source to the power tool or machinery.** This can cause injury as tools and machinery can suddenly fire incidentally when live, causing accidents.
- **Use all provided dust collection and extraction attachments, if included.** This equipment, along with the use of PPE dust masks, can help keep you safe from dust inhalation, and keep your work site clear from hazards.
- **Ensure loose parts such as wrenches or adjusting keys are removed before starting the power tool or machinery.**



SAFETY GUIDELINES

Power Tool & Machinery Use & Care

- **Use the correct tool for the job.** Forcing a tool to do a job it was not designed for increases the risk of accident or injury.
- **Disconnect tools and machinery from power, or remove batteries before doing any maintenance or adjustments, or before storing the tools and machinery.** This reduces or removes the risk of a power connection that causes the tool or machinery to accidentally fire, which can help prevent injury or accident.
- **Check the general condition of the power tool for damage or any problems that could affect the way the tool or machine works.** An unrepaired tool or machine can lead to accident and injury. Only have your tool or machine repaired with genuine parts from your local distributor
- **Only use the power tool and machinery with genuine parts or accessories that are designed to be used with this power tool and machinery.** Failure to do so could result in accident or injury, or damage your tool or machinery.
- **Store your tool or machinery out of reach of children, and away from untrained personnel when not in use.** Use by somebody untrained, or a child, could lead to accident or serious injury.

Service

- **Have your tools and machinery serviced by your local distributor with genuine XHD Lithium replacement parts.** This will ensure that the safety of the power tool or machine is maintained.

 **WARNING**

The warnings and precautions discussed in this manual cannot cover all possible conditions and situations that may occur. It must be understood by the operator that common sense and caution are factors which cannot be built into this product, but must be supplied by the operator.

Always Use Common Sense

- It is not possible to cover every conceivable situation you can face. Always exercise care and use your common sense. If you get into a situation where you feel unsafe, stop and seek expert advice. Contact your dealer, service agent, or an experienced user. Do not attempt any task you feel unsure of!
- **Do not let familiarity gained from the frequent use of tools allow you to become complacent and ignore tool safety principles.** A careless action can cause severe injury within a fraction of a second.



SAFETY GUIDELINES

Battery Tool Use & Care

- Prevent unintentional starting. Ensure the switch is in the OFF position before connecting to the battery pack, picking up, or carrying the machine. Carrying the machine with your finger on the switch or energising a machine that has the switch ON invites accidents.
- Disconnect the battery pack from the machine before making any adjustments, changing accessories, or storing the machine. Such preventive safety measures reduce the risk of starting the machine accidentally.
- Recharge the battery only with the charger specified by the manufacturer. A charger that is suitable for one type of battery pack may create a risk of fire when used with another battery pack.
- Use machines only with specifically designated battery packs. Use of any other battery packs may create a risk of injury and fire.
- When the battery pack is not in use, keep it away from other metal objects, like paper clips, coins, keys, nails, screws, or small metal objects, that can make a connection from one terminal to another. Shorting the battery terminals together may cause burns or a fire.
- Under abusive conditions, liquid may be ejected from the battery; avoid contact. If contact accidentally occurs, flush the area with water. If liquid contacts eyes, seek medical help. Liquid ejected from the battery may be acidic and may cause irritation or burns.
- Do not use a battery pack or machine that is damaged or modified.

fied batteries may exhibit unpredictable behaviour resulting in fire, explosion, or risk of injury.

- Do not expose a battery pack or machine to fire or excessive temperature. Exposure to fire or temperature above 130°C may cause explosion.
- Follow all charging instructions and do not charge the battery pack or machine outside of the temperature range specified in the instructions.
- Charging the battery improperly, or at temperatures outside of the specified range may damage the battery and increase the risk of fire.
- Have servicing performed by a local XHD distributor repair person using only identical replacement parts. This will ensure that the safety of the product is maintained.
- Do not modify or attempt to repair the machine or the battery pack except as indicated in the instructions for use and care.

Battery Long Life Tips

- Charge the battery cartridge before it is completely discharged. Always stop tool operation and charge the battery cartridge when you notice less tool power.
- Never recharge a fully charged battery cartridge. Overcharging shortens the battery service life.
- Charge the battery cartridge with room temperature at 10°C – 40°C. Allow a hot battery cartridge to cool before charging it.
- Charge the battery cartridge once in every six months if you do not use it for extended periods at a time.

SAFETY GUIDELINES

Blower Specific Safety

- Always wear PPE suitable footwear and long trousers while operating the machine.
- Do not wear loose clothing or jewellery that can be drawn into the air inlet. Keep long hair away from the air inlets.
- Always use protective goggles, a cap, and mask when using the machine. Ordinary eye or sun glasses are NOT safety glasses.
- To prevent dust irritation, the wearing of a PPE face mask is recommended.
- While operating the blower, always wear non-slip and protective footwear. Non-skid, closed-toed safety boots and shoes will reduce the risk of injury.
- Switch off the machine and remove the battery cartridge and make sure that all moving parts have come to a complete stop:
 1. Whenever you leave the machine.
 2. Before checking, cleaning, or working on the machine.
 3. If the machine starts to vibrate abnormally.
 4. Whenever you convert the machine from blower to vacuum, and vice versa.
- Operate the machine only in daylight or in good artificial light.
- Do not overreach and keep proper balance and footing at all times.
- Never blow debris in the direction of bystanders.
- Operate the machine in a recommended position and on a firm surface.
- Do not operate the machine at high places.
- Never point the nozzle at anyone in the vicinity when using the machine.
- Never block the suction inlet or blower outlet.
- Be careful not to accidentally block the suction inlet or blower outlet with dust or dirt when operating in dusty area.
- Do not use the blower to inflate balls, rubber boat, or the similar.
- Do not operate the machine near open windows, etc.
- Using rakes and brooms to loosen debris before blowing is recommended.
- If the machine strikes any foreign objects or should start making any unusual noise or vibration, immediately switch off the machine. Remove the battery cartridge from the machine and inspect the machine for damage before restarting and operating the machine. If the machine is damaged, contact your nearest XHD Lithium dealer for repair.
- Do not insert fingers or other objects into suction inlet or blower outlet.
- Prevent unintentional starting. Ensure the switch is in the OFF position before inserting the battery, picking up, or carrying the machine. Carrying the machine with your finger on the switch, or energising the machine while the switch is on invites accidents.
- Never blow or vacuum dangerous materials, such as nails, fragments of glass, or blades.
- Do not operate the machine near flammable materials.
- Avoid operating the machine for a long time in a low temperature environment.
- Always use the dust bag when collecting dust, chips, and the like.
- Do not collect still smouldering cigarette ashes, freshly cut metals shavings, screws, nails, and the like.

OPERATION

WARNING

Always be sure that the tool is switched off and the battery cartridge is removed before adjusting or checking the tool.

Installing or Removing the Battery

- To remove the battery cartridge, slide it from the tool while depressing the button on the front of the cartridge.
- To install the battery cartridge, align the tongue on the battery cartridge with the groove in the housing and slip it into place. Insert it all the way until it locks in place with a little click. If you can see the red indicator on the upper side of the button, that means it is not locked completely.

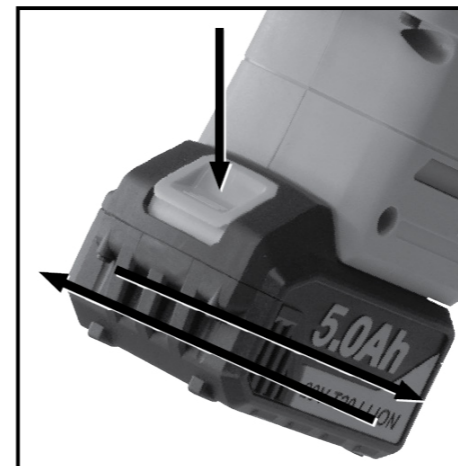

CAUTION

Do not install the battery cartridge forcibly. If the cartridge does not slide in easily, it is not being inserted correctly.

Indicating the Remaining Battery Capacity

- Press the check button on the battery cartridge to indicate the remaining battery capacity. The indicator will light up for few seconds.

NOTE: Depending on the conditions of use and the ambient temperature, the indication may differ slightly from the actual capacity.



INDICATOR LAMPS			REMAINING CAPACITY
LIGHTED	OFF	BLINKING	
■	□	▣	75% to 100%
■	■	□	50% to 75%
■	■	□	25% to 50%
■	□	□	0% to 25%
▣	□	□	Charge the Battery.
■	■	□	The Battery may have Malfunctioned
□	□	■	

ASSEMBLY

Tool/Battery Protection System

- The tool is equipped with a tool/battery protection system. This system automatically cuts off power to the motor to extend tool and battery life. The tool will automatically stop during operation if the tool or battery is placed under one of the following conditions:

Overload Protection

- When the tool/battery is operated in a manner that causes it to draw an abnormally high current, the tool automatically stops without any indication. In this situation, turn the tool off and stop the application that caused the tool to become overloaded. Then turn the tool on to restart.

Overheat Protection

- When the tool/battery is overheated, the tool stops automatically. In this situation, let the tool/battery cool before turning the tool on again.

Over Discharge Protection

- When the battery capacity is not enough, the tool stops automatically. In this case, remove the battery from the tool and charge the battery.

CAUTION

Before installing the battery cartridge into the tool, always check to see that the switch trigger actuates properly and returns to the "OFF" position when released.

Attaching The Blower Tube (Fig 1–2)

- Align the widest end of the blower tube (6) with the front opening on the blower outlet (7). Slide the blower tube over blower outlet, lining up the blower tube slot with the blower outlet tab.
- Rotate the blower tube clockwise to lock into place (Fig. 2).

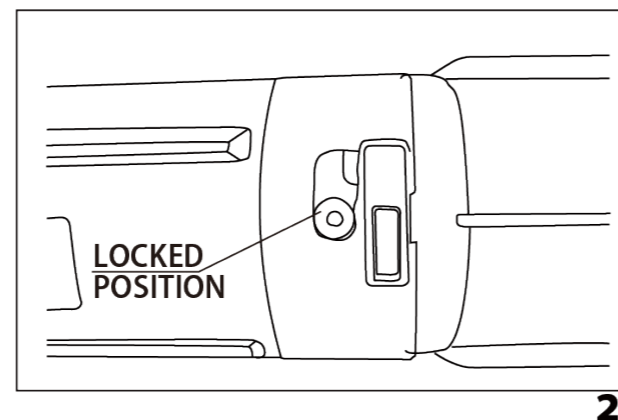
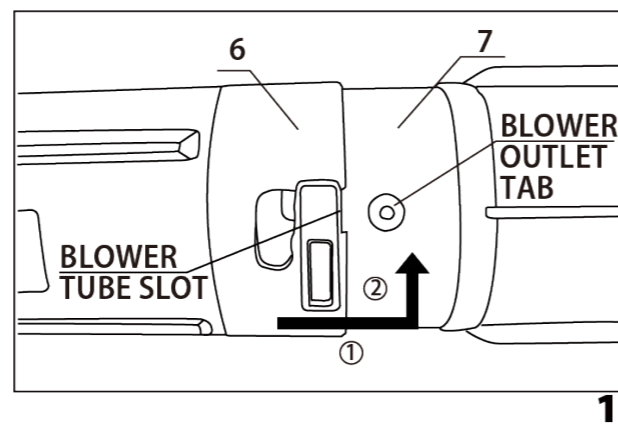

OPERATION

WARNING

To avoid serious injury and property damage: Inspect area before using the blower. Remove all hard objects. Do not blow debris in the direction of people, animals, or property.

Starting/Stopping The Blower (Fig. 3)

- Hold the blower with your preferred hand, with the tube several centimetres off the ground.
- Press and hold down the On/Off switch (1) to start the blower, and then release it once the blower has started.
- Press and hold the TURBO speed switch (2), to increase air speed. Release the TURBO speed switch to resume normal air speed.
- To stop the blower press the On/Off switch.

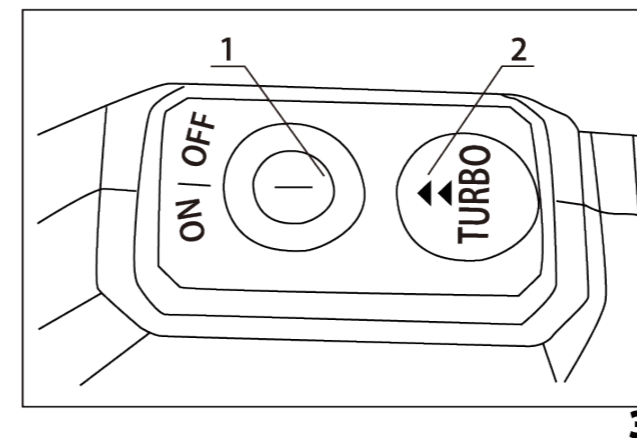

Turbo Speed Mode (Fig. 3)

- Press and hold the TURBO speed switch (2) to increase air speed. Release it to resume normal air speed.

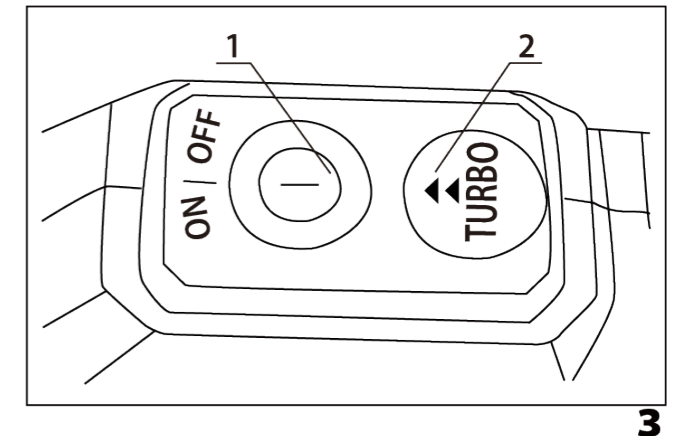

Variable Air Speed (Fig. 4)

- Rotate the variable speed adjust lever anti-clockwise to increase air speed, or rotate it clockwise to decrease air speed.

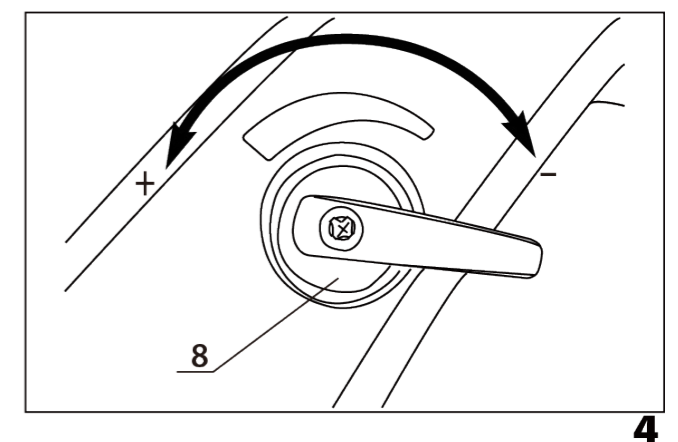

OPERATION

WARNING

Battery tools are always in operating condition. Therefore, switch should always be in the OFF position when not in use or carrying at your side.

Charging Battery Pack

- Read and follow all warnings and instructions in owner's manual of the ToolShed XHD TSC3 18 Volt Dual Battery Charger.

Installing and Removing Battery Pack (Fig. 5)

- To install battery pack, align the battery connection port (5) with the groove in the battery pack and push in the direction of the arrow until the battery pack is secured on the tool.
- Repeat this procedure for the second battery.
- To remove the battery pack from the tool, push the battery clip on and remove the battery pack in the direction of the arrow.

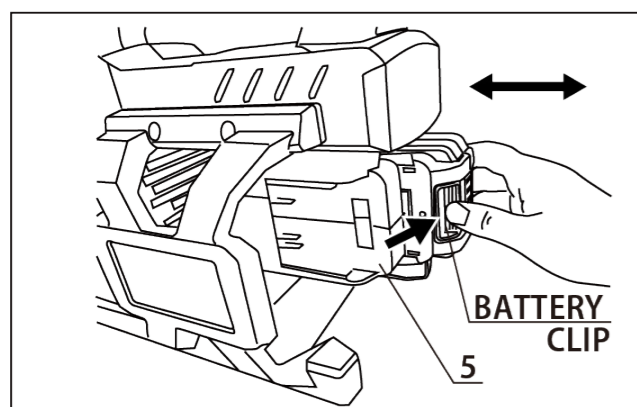

5

WARNING

Always remove the battery packs from your tool when you are assembling parts, making adjustments, cleaning, carrying, transporting or when not in use. Removing the battery packs will prevent accidental starting that could cause serious personal injury.

WARNING

Do not at any time let brake fluids, gasoline, petroleum-based products, penetrating oils, etc., come in contact with plastic parts. Chemicals can damage, weaken or destroy plastic which may result in serious personal injury.

MAINTENANCE

WARNING

When servicing, use only identical replacement parts. Use of any other parts may create a hazard or cause product damage.

WARNING

Always wear safety goggles or safety glasses with side shields during power tool operation or when blowing dust. If operation is dusty, also wear a dust mask.

WARNING

To avoid serious personal injury, always remove the battery pack from the product when cleaning or performing any maintenance. Avoid using solvents when cleaning plastic parts.

STORAGE

- Clean all foreign material from the blower.
- Store indoors in a place that is inaccessible to children. Keep away from corrosive agents such as garden chemicals and de-icing salts.